



2 REAR ELEVATION



4 LEFT ELEVATION

COLOR SCHEME KEY

- | | |
|---|--|
| 1 | MAIN
SW 7757
HIGH REFLECTIVE WHITE |
| 2 | TRIMS
SW 7631
CITY LOFT |
| 3 | DETAIL COLOR
SW 7014
EIDER WHITE |
| 4 | SHUTTERS
SW 6766
MARINER |
| 5 | AWNING/BRACKETS
SW 9183
DARK CLOVE |
| 6 | RAILINGS/WINDOWS/
DOOR FRAMES
SW 7048
URBANE BRONZE |
| 7 | ROOFS
BARREL TILES
REDDISH ORANGE |
| 8 | STONE VENEER
FRENCH LIMESTONE CREAM |

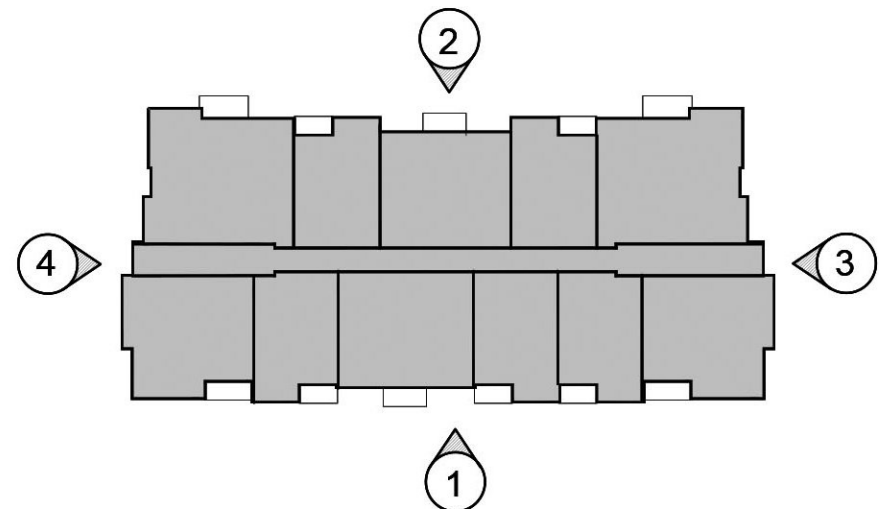

KEYPLAN

N.T.S

BLDG IA ELEVATIONS

SCALE: 1/8"=1'-0"

P&Z

PZ23-12000017

PRE-APP MEETING 04/04/2023	BY
DRC SUBMITTAL 06/13/2023	
DRC RE-SUBMITTAL 08/16/2023	
DRC RE-SUBMITTAL 01/01/2024	
DRC RE-SUBMITTAL 10/16/2024	
DRC RE-SUBMITTAL 12/10/2024	
DRC RE-SUBMITTAL 01/29/2025	

OAKS @ PALM AIRE
FOR:
MORGUARD
LOCATED AT:
POMPANO BEACH, FLORIDA

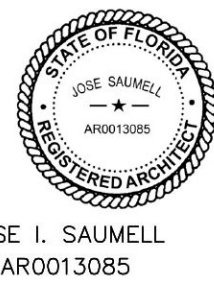

MSA ARCHITECTS, INC.
A40000895

MSA ARCHITECTS
ARCHITECTURE & PLANNING

COPYRIGHT © 2022 MSA ARCHITECTS, INC. THE ARCHITECTURAL DESIGN AND DETAIL DRAWINGS FOR THIS BUILDING AND/OR OVERALL PROJECT ARE THE LEGAL PROPERTY OF AND ALL RIGHTS ARE RESERVED BY THE ARCHITECT. THEIR USE FOR REPRODUCTION, CONSTRUCTION, OR DISTRIBUTION IS PROHIBITED UNLESS AUTHORIZED IN WRITING BY THE ARCHITECT.

DRAWN
CONTRACT DATE 10/12/22
SCALE AS SHOWN
JOB NO. 2181.PRJ
SHEET TITLE:

BLDG ELEVATIONS

SHEET NUMBER:

A-3.1.2A